

**AB<sup>®</sup>**  
**Courtyard**  
 Collection™

# Building Corners

## Basic steps for building corners

The AB Courtyard Collection is designed to let you easily make corners using the Corner Block. Splitting blocks will be required on every course. See the How-to sheet #210 for information on splitting.

Walls can be built on existing patios or pavement, as well as on soil. See *How-to sheet #120* for more information on building in soil.



### Step 1: Layout

Walls that have corners in the design will need to be built starting at the corner.

Determine the location of the corner and place a Corner Block.

#### Corner Block

Short Side

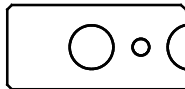

Long Side



### Step 2: Build the Corner

Next split a AB Dublin end-split (as shown here), or a AB York center-split block along the splitting notch and place the split end against the the Corner Block to create the corner, see Pattern A. Splitting the block creates a straight edge so there will not be a gap where the blocks meet. See *How-to sheet #210* for more information on splitting blocks.



Corner Block



AB Dublin end-split block



AB York center-split block



Wall Cap

Placement of AB Dublin end-split block (larger side)

#### Pattern A

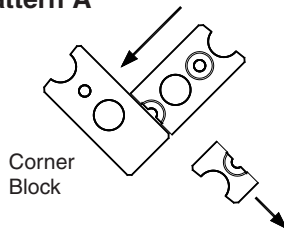

Corner Block

Placement of AB Dublin end-split block (smaller side)

#### Pattern B

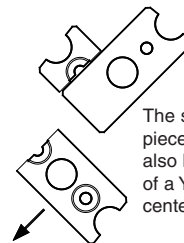

Use the large piece on one course, use the smaller piece on the next course.

The smaller piece can also be half of a York center-split.

### Step 3: Second Course

Install the first two courses at the same time. This will ensure proper alignment of the entire project. On this course, alternate the position of the corner block to face the opposite direction of the one on the first course. Use the remaining split piece and place it with the split side against the corner to finish the corner.

### Step 4: Continue Building

Build the remaining wall out in both directions in the pattern chosen. Use the above process for any additional courses or corners in the project.



allanblock.com

For a complete library of AB Courtyard Collection How-to sheets visit [allanblock.com](http://allanblock.com)

# Building Corners

## Basic steps for building corners

### Step 5: Wall Caps First Direction

Finish the corner with Wall Caps. Starting at the corner place the first two Wall Caps following the wall in the same direction. Place the first Wall Cap with the long end facing the outside of the wall. Alternate the direction of the second Wall Cap for a straight wall.

#### Wall Cap

Long end



Short end



### Step 6: Wall Caps Second Direction

Next place a Wall Cap on the other side of the corner. Place the short end of the Wall Cap facing the outside of the wall. Make adjustments to the first two Wall Caps to ensure they line up properly at the corner.

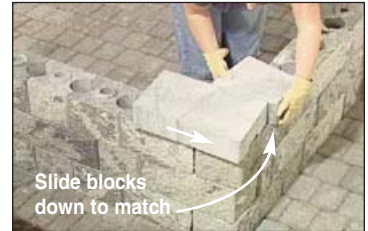

### Step 7: Finish

Secure the Wall Caps in place with a bead of masonry adhesive along both sides of the raised rings and along the side of each Wall Cap (adhesive optional).



### Cutting Caps for the Corner (Optional)

Finishing the corner with Wall Caps can be done as shown above, or by modifying the cap slightly gives the corner a more refined look.

#### Step 1: Mark and Cut Caps

Using a tape measure and straight edge, mark the cut line on two cap blocks as shown. Use a masonry saw with a dry cutting diamond blade to make a complete cut.

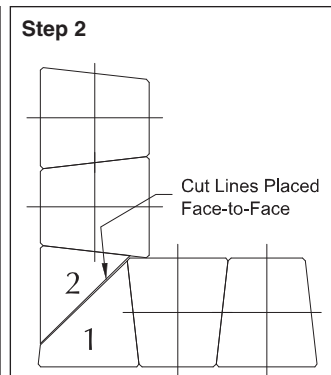
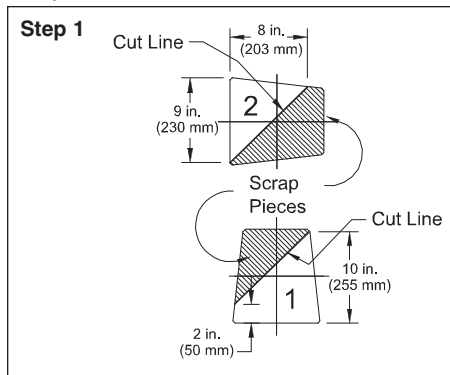

#### Step 2: Place Caps on Corner

Place the cut caps on the corner as shown. Continue stacking additional caps out from the corner.



#### Step 3: Finish

Secure the Wall Caps in place with a bead of masonry adhesive along both sides of the raised rings and along the side of each Wall Cap (adhesive optional).

The information shown here is for use with the Allan Block Courtyard products only.



allanblock.com